

Kitbashing a prefab

Smart Models RES09B produce a downloadable card building kit for a prefab house.

This is my take on those from my area, which were not similar to the the design used in the kit.



I always remember they had a metal canopy over the front door, so I made one out of a bit of scrap brass.

Also, the prefab I live in had a pyramid shape on which the chimney sat.

I left off the concrete extension round the windows and doors as they were not of my local style.

The kit's internal layout is as shown and does not match that of my one.

The kitchen, hallway, sitting room and front bedroom are identical, but mine had a bathroom and a separate toilet with a much smaller second bedroom. Also my rear door was at the rear of the kitchen instead of on the side wall.

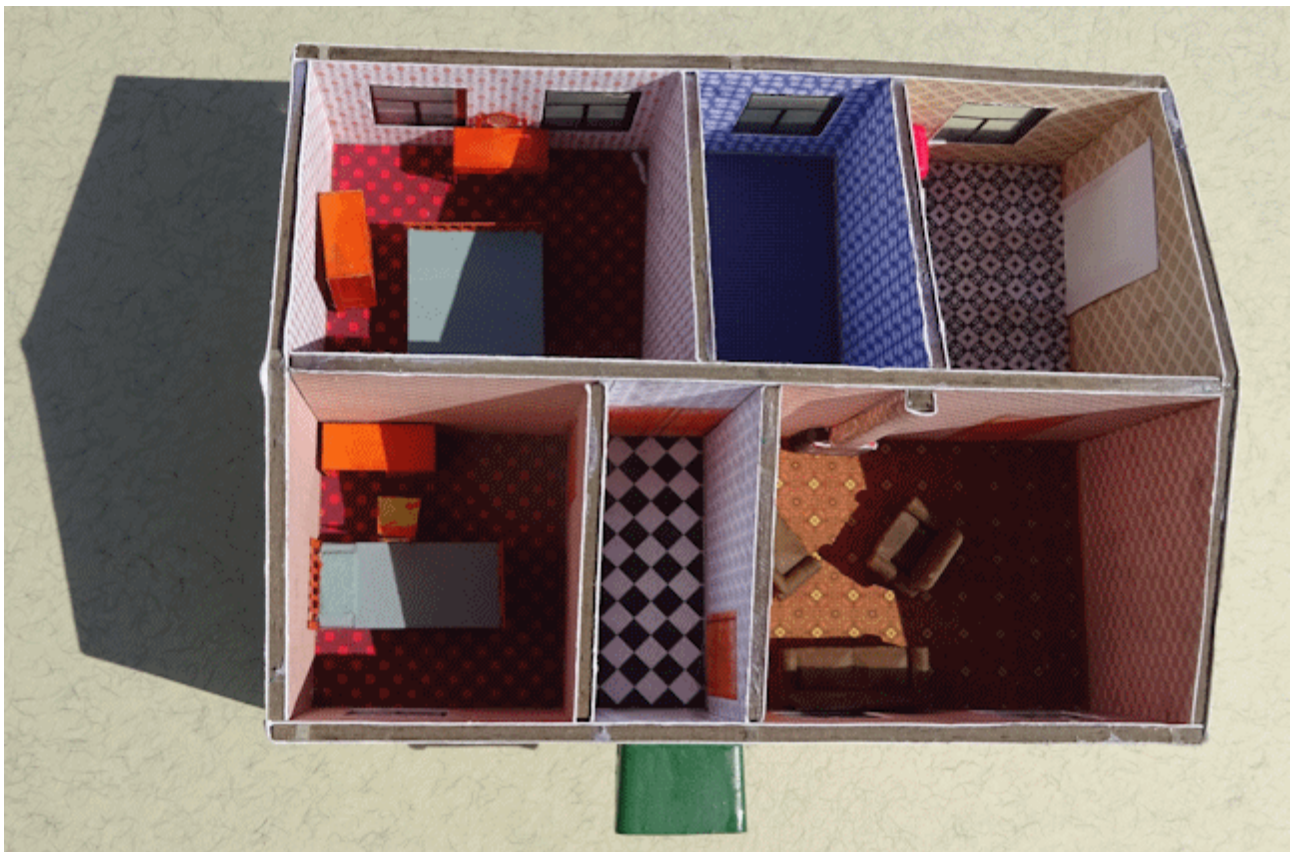

This furniture is brass etched and supplied by Severn Models (<https://severnmodels.com/>)
You just fold and either solder or just super glue.
They are finely detailed and available in N, 00, 0, etc. gauges.

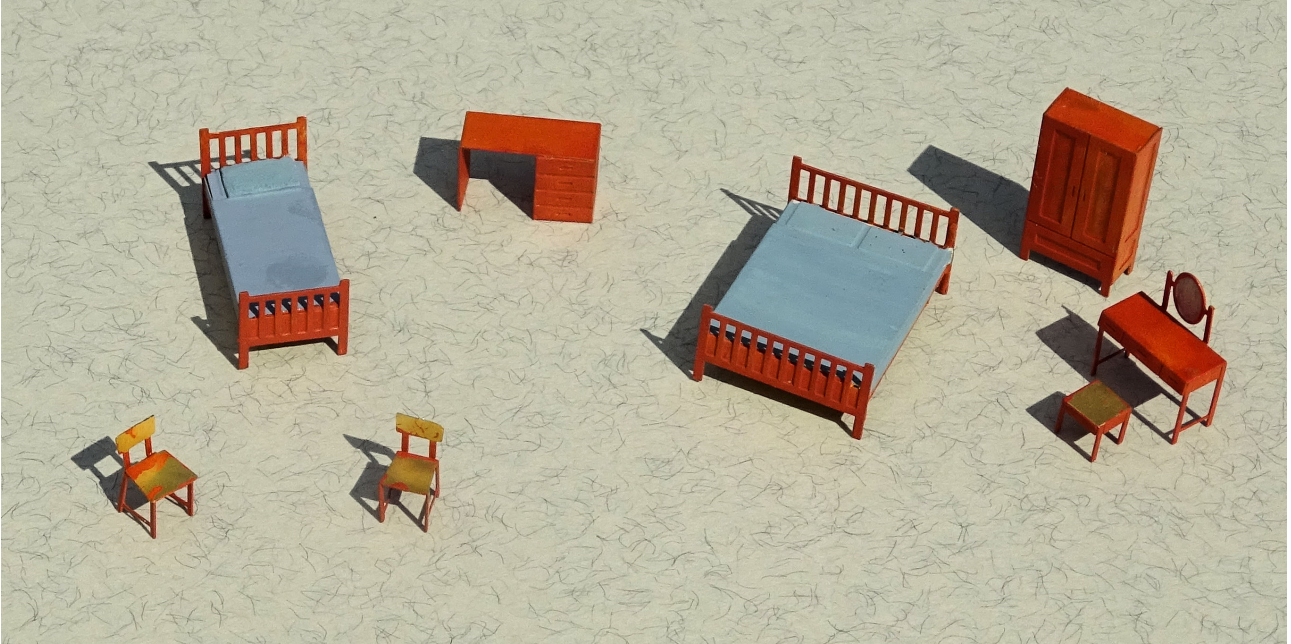

Gordon Campbell